

PRODUCT FEATURES

- High tin low calcium alloy grids designed to resist corrosion;
- Patent multi-layer polarity sealing structure, safety and reliable leakage-proof performance
- Patent composite grid structure and plate of high humidity and high temperature curing process which prolong life;
- High purity row and auxiliary

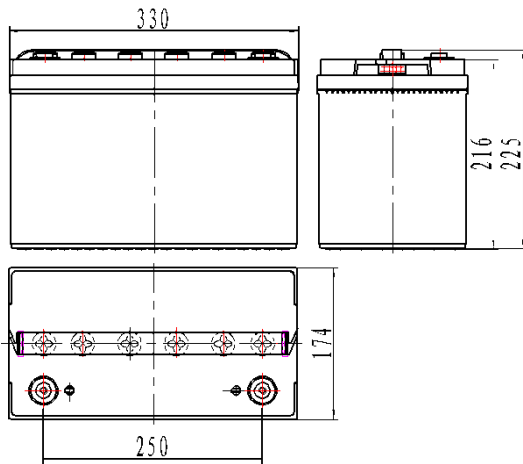

APPLICATIONS

- UPS/EPS
- Emergency lighting
- Communication equipment;
- Renewable Energy
- Power tool
- Universal

CONFORMANCE STANDARDS

- GB/T 19639.1-2005;
- IEC 61056-1/2:2002
- JIS C8702-1/2: 2009;
- Passed ISO9001、
- ISO14001、OHSAS18001、
- UL and CE certificates
- Eurobat guide;
- installation compliant with:EN50272-2

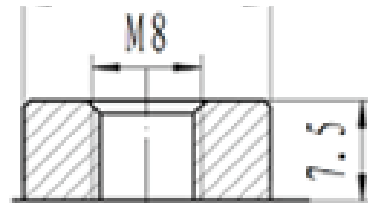

GFM-22

Battery Model	EVP-12-100SN			
Designed Life	10Years			
Capacity(25°C)	20HR(5.0A,1.75V)	10HR(9.3A,1.75V)	5HR(17.0A,1.75V)	1HR(60.0A,1.70V)
	100AH	93AH	85AH	60AH
Dimensions	Length	Width	Height	Total Height
	330mm	174mm	216mm	225mm
Approx. Weight	29.8kg			
Internal Resistance	4.0m Ω			
Max Discharge Current	1000A(5Sec.)			
Self-Discharge	≤2%permonths (25°C)			
Charge Voltage(25°C)	Cycle use		Float use	
	14.7V(-24mV/°C),maxchargecurrent:30A		13.62V(-18mV/°C)	

Discharge Parameter:

Constant current discharge data (25°C, A)													
End voltage (V/cell)	5min	10min	15min	20min	30min	45min	1h	1.5h	2h	3h	5h	10h	20h
1.60	335.0	236.0	181.0	148.0	110.0	80.00	63.50	47.30	37.30	26.80	17.63	9.600	5.130
1.65	315.0	227.0	175.0	144.0	107.0	78.00	61.90	46.50	36.90	26.50	17.40	9.500	5.100
1.70	292.0	216.0	169.0	140.0	104.0	76.00	60.00	45.60	36.20	26.20	17.20	9.400	5.050
1.75	262.0	201.0	162.0	135.0	101.0	74.00	58.70	45.00	35.30	25.70	17.00	9.300	5.000
1.80	237.0	184.0	153.9	129.0	97.00	72.50	57.10	43.50	34.50	25.20	16.60	9.100	4.900

Constant power discharge data (25°C, W/cell)													
End voltage	5min	10min	15min	20min	30min	45min	1h	1.5h	2h	3h	5h	10h	20h
1.60	565.0	422.0	329.0	272.4	204.0	151.0	119.0	88.00	69.70	50.50	33.30	18.80	10.38
1.65	540.0	410.0	323.0	266.9	201.0	147.6	117.7	87.06	69.13	50.13	33.07	18.55	10.32
1.70	509.0	394.0	315.0	261.5	197.0	144.5	116.0	86.13	68.44	49.69	32.87	18.36	10.27
1.75	467.0	372.0	304.0	253.6	192.0	141.5	113.5	85.12	67.68	49.28	32.62	18.16	10.20
1.80	429.0	346.9	290.0	244.0	186.0	139.0	111.0	83.50	66.50	48.50	32.30	17.95	10.00

Performance Curve:

